

**Surveyor's Statement:**

I, Thomas A. Tremel, a Registered Land Surveyor in the State of Nebraska, hereby state that this survey was conducted under my direct supervision and is correct to the best of my knowledge and belief.

*Thomas A. Tremel*  
 Thomas A. Tremel, L.S. #455  
 October 14, 2021

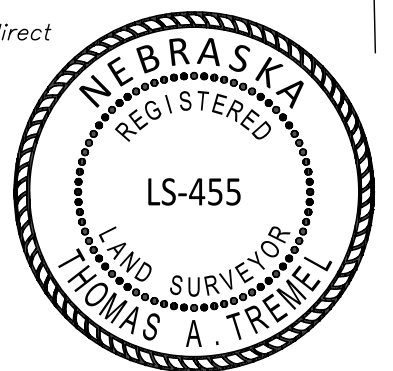

**-Legend-**

- Found 5/8" Rebar w/ Plastic Survey Cap (Unless Otherwise Noted)
- Set 5/8" x 24" Rebar w/ Plastic Survey Cap
- x Computed Location
- M Measured this Survey
- K Recorded Measurement Richard Kingman, L.S. #595
- C Recorded Measurement J.A. Charles, L.S. #618
- P Plat Measurement General Land Office
- P.O.B. Point of Beginning

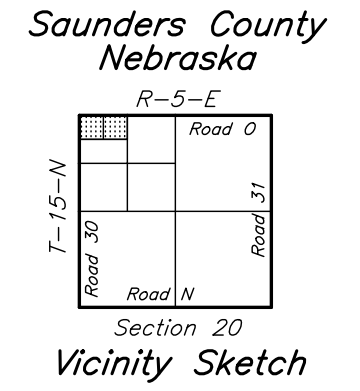
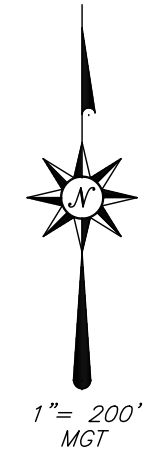

**Field Notes:**

Northwest Corner NW1/4 NW1/4, Section 20, T15N, R5E – found 5/8" rebar 4" deep as recorded by Richard Kingman, L.S. #595 on June 9, 2020.  
 Ties: 40.65' NW to "X" nails in power pole  
 73.81' NNE to "X" nails in power pole  
 8' South to County Road 0 E&W  
 On centerline of County Road 30 N&S

Northeast Corner NW1/4 NW1/4, Section 20, T15N, R5E – found 5/8" rebar with plastic cap 4" deep as recorded by Richard Kingman, L.S. #595 on June 9, 2020.  
 Ties: 33.02' South to 5/8" rebar with plastic cap  
 33.47' NNW to nail in brace post  
 36.07' NE to 5/8" rebar  
 2' South to centerline of County Road 0 E&W

Southeast Corner NW1/4 NW1/4, Section 20, T15N, R5E – found 5/8" rebar North of red flint boulder as recorded by Richard Kingman, L.S. #595 on June 9, 2020.  
 Ties: 10.01' WNW to 5/8" rebar  
 44.31' ENE to 5/8" rebar  
 On range of fence East and West

W1/4 Corner, Section 20, T15N, R5E – found 5/8" rebar with aluminum cap stamped L.S. 618 2" deep as recorded by J.A. Charles, L.S. #618 on February 6, 2012.  
 Ties: 37.20' NW to "X" nails in fence post  
 31.59' West to "X" nails in corner fence post  
 83.61' SSW to "X" nails in power pole  
 3' West to centerline of County Road 30 N&S

**Tract 1 Description:**

A tract of land located in the NW1/4 of the NW1/4 of Section 20, T15N, R5E of the 6th P.M., Saunders County, Nebraska more particularly described as follows: beginning at the Northwest corner of said NW1/4 NW1/4; thence S 87°34'39" E, 658.00 ft. on the North line of said NW1/4 NW1/4; thence S 00°41'49" E, 662.67 ft. parallel with the West line of said NW1/4 NW1/4; thence N 87°34'39" W, 658.00 ft. parallel with the North line of said NW1/4 NW1/4 to the West line thereof; thence N 00°41'49" W, 662.67 ft. to the point of beginning, containing 10.00 acres more or less, which includes 0.98 acres used for county road purposes.

**Tract 2 Description:**

A tract of land located in the NW1/4 of the NW1/4 of Section 20, T15N, R5E of the 6th P.M., Saunders County, Nebraska more particularly described as follows: referring to the Northwest corner of said NW1/4 NW1/4; thence S 87°34'39" E, 658.00 ft. on the North line of said NW1/4 NW1/4 to the point of beginning; thence continuing S 87°34'39" E, 649.16 ft. on the North line of said NW1/4 NW1/4 to the Northeast corner thereof; thence S 01°17'15" E, 663.08 ft. on the East line of said NW1/4 NW1/4; thence N 87°34'39" W, 656.00 ft. parallel with the North line of said NW1/4 NW1/4; thence N 00°41'49" W, 662.67 ft. parallel with the West line of said NW1/4 NW1/4 to the point of beginning, containing 9.91 acres more or less, which includes 0.49 acres used for county road purposes.